

Brio®

Price book 6

Effective February 27, 2026



This price list supersedes and cancels all previous price lists. Prices shown are subject to change without notice.

Customer care

Our Customer Care Representatives are available for questions or assistance.

1-585-319-5599

Placing orders

You can place orders with Allegion via the phone number and email listed below:

Brio USA

☎ 1-585-319-5599

✉ Brio.Orders.USA@allegion.com

Technical product support

☎ 1-585-319-5599

✉ Brio.Sales.USA@allegion.com

Request for quote

✉ Brio.Sales.USA@allegion.com

Administrative offices

Allegion administrative office

11819 N. Pennsylvania St.

Carmel, IN 46032

allegion.com/us

Sales support

Carolinas

(North Carolina, South Carolina, Virginia)

Carolinas_Sales_Support@allegion.com

Central

(Illinois, Iowa, Kansas, Missouri, Nebraska)

Central_Sales_Support@allegion.com

Chicago

(Northern Illinois, Wisconsin)

Chicago_Sales_Support@allegion.com

Florida

Florida_Sales_Support@allegion.com

Metro New York

(Metro New York, Northern New Jersey)

Metro_Sales_Support@allegion.com

Michigan

Michigan_Sales_Support@allegion.com

Mid Atlantic North

(New York, Western Pennsylvania)

Mid_Atlantic_North_Sales_Support@allegion.com

Mid Atlantic South

(Delaware, Eastern Pennsylvania, Maryland, Northern Virginia, Southern New Jersey, Washington DC)

Mid_Atlantic_South_Sales_Support@allegion.com

Midwest

(Indiana, Kentucky, Ohio, West Virginia)

Midwest_Sales_Support@allegion.com

Mountain States

(Colorado, Idaho, Montana, Nevada, Utah, Wyoming)

Mountain_States_Sales_Support@allegion.com

New England

(Connecticut, Maine, Massachusetts, New Hampshire, Rhode Island, Vermont)

New_England_Sales_Support@allegion.com

North Central

(Minnesota, North Dakota, South Dakota)

North_Central_Sales_Support@allegion.com

Northern California

Northern_California_Sales_Support@allegion.com

Northwest

(Alaska, Oregon, Washington)

Northwest_Sales_Support@allegion.com

South

(Alabama, Georgia, Louisiana, Mississippi, Tennessee)

South_Sales_Support@allegion.com

Southern California

(Southern California, Hawaii)

Southern_California_Sales_Support@allegion.com

Southwest

(Arizona, New Mexico)

Southwest_Sales_Support@allegion.com

Texas

(Arkansas, Texas, Oklahoma)

Texas_Sales_Support@allegion.com

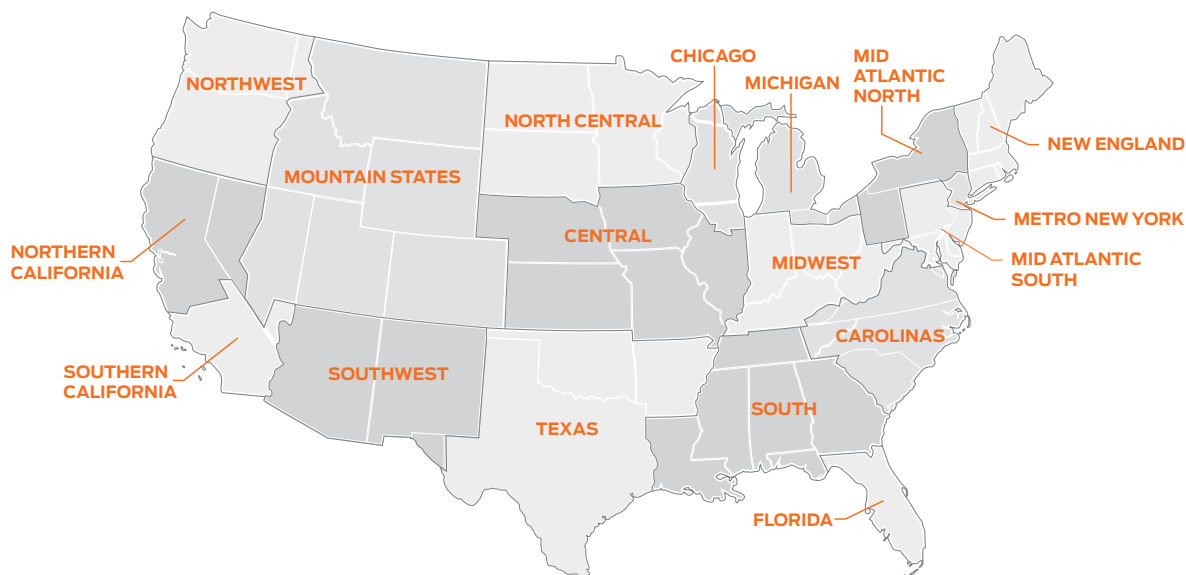

Brio® where ideas unfold

Brio®, based in the USA, Australia and UK, is focused on bringing adventurous architectural ideas to life, converting the conceptual thoughts of our customers into exciting reality.

Our aim is that Brio® be seen as the innovative leader in sliding and folding door hardware – a leader in design and quality.

Brio® epitomises our core values. Energy. Spirit. Vitality. It also stands for the way we approach the discovery of new solutions for our customers.

Brio®'s R&D department brings a strong design element to the business, developing and testing new concepts using the latest CAD and modelling software.

The company embraces the concept of generic and private label enterprises and recognizes the need for specialization in certain circumstances and markets.

Brio, part of the Allegion family of brands.

BRIO – USA

2201 100th St. SW
Everett, WA 98204
USA

Telephone: +1-585-319-5599

Email: Brio.Sales.USA@allegion.com

Website: BrioUSA.com

Table of Contents and Application Selection Guide

System	Application	Residential	Commercial	Max Panel Weight	Panel Thickness	Max Panel Height	Max Panel Width	Interior	Exterior	Page
Alpha-numeric										ii
Straight Sliding Top Hung Systems										
Open Bar Rail Wood 80	Room Divider	●	●	175lbs	1 3/8" – 1 3/4"	118 1/8"	49 1/4"			1
Open Round Rail Wood 100	Room Divider	●	●	220lbs	1 3/8" – 1 3/4"	118 1/8"	78 3/4"			2
Open Square Rail Wood 150	Room Divider	●	●	330lbs	1 3/8" – 1 3/4"	118 1/8"	78 3/4"			3
Quick Run 120	Room Divider	●	●	265lbs	1.1" – 1 1/4"	118 1/8"	59"			4

Policies and documents

The purchase of Allegion products is governed by the Allegion Authorized Seller Program. For program terms and conditions, and other program details, please visit: www.allegion.com/AuthorizedSeller.

For Warranty information, visit www.briouusa.com or contact Customer Service at 1-585-319-5599.

Sustainability

Allegion can provide sustainability documentation for select products, ensuring transparency and adherence to environmental standards and building certification programs such as LEED and Living Building Challenge. This documentation includes detailed information on the sustainable practices and materials used, helping you make informed decisions that align with your sustainability goals.

To view the full list of products with declarations, please visit: <https://us.allegion.com/en/resources/sustainability.html>.

Pricing / product description subject to change without notice.

Ref. #	Description	Price \$	Page	Ref. #	Description	Price \$	Page
57JNP	Hanger surface mount pair	\$169.77	4	94PPA-BR40	Poly. & Support, Bronze Anod - 4000mm (157 1/2")	\$235.11	2
58JNP	Hanger recessed mount pair	\$169.77	4	94PPA-BR60	Poly. & Support, Bronze Anod - 6096mm (240")	\$352.65	2
61JNP	Hanger zero clearance mount pair	\$306.04	4	OBF80-20	Open Bar Rail Wood Pack Set SS - 2000mm (78 3/4")	\$844.22	1
120CS	Clip Stop	\$22.14	4	OBF80-20PB	Open Bar Rail Wood Pack Set Black - 2000mm (78 3/4")	\$519.53	1
120SCT	Soft Close	\$120.94	4	OBF80-25	Open Bar Rail Wood Pack Set SS - 2500mm (98 3/8")	\$955.55	1
120F-A60	Flush track aluminum anod, 6000mm	\$490.00	4	OBF80-25PB	Open Bar Rail Wood Pack Set Black - 2500mm (98 3/8")	\$630.85	1
120F-A40	Flush track aluminum anod, 4000mm	\$326.49	4	ORFI00	Open Round Rail Wood Hanger Set Face Fix	\$1,253.35	2
120F-A30	Flush track aluminum anod, 3000mm	\$256.07	4	ORFI00PR	Open Round Rail Wood Hanger Set Face Fix PR	\$1,606.43	2
120F-A20	Flush track aluminum anod, 2000mm	\$169.77	4	ORTI00	Open Round Rail Wood fittings pack	\$1,194.19	2
100F-RB	Support Bracket	\$41.75	2	ORTI00PR	Open Round Rail Wood Hanger Set PR	\$1,507.17	2
100F-RBPR	Support Bracket for Round Rail PR	\$65.68	2	OSTI50	Open Square Rail Wood fittings pack	\$1,757.40	3
100OR-20	Open Round Rail - 2000mm (78 3/4")	\$388.53	2	OSTI50PR	Open Square Rail Wood Hanger Set PR	\$2,217.63	3
100OR-20PR	Open Round Rail - 2000mm (78 3/4") PR	\$526.58	2				
100OR-25	Open Round Rail - 2500mm (98 3/8")	\$485.60	2				
100OR-25PR	Open Round Rail - 2500mm (98 3/8") PR	\$658.14	2				
100OR-30	Open Round Rail - 3000mm (118 1/8")	\$582.70	2				
100OR-30PR	Open Round Rail - 3000mm (118 1/8") PR	\$789.69	2				
100OR-40	Open Round Rail - 4000mm (157 1/2")	\$777.04	2				
100-RB	Support Bracket for Round Rail	\$33.55	2				
100-RBPR	Support Bracket for Round Rail PR	\$45.45	2				
106E/94	Guide with nylon roller - use with 94A, 94B, 94P	\$34.13	2				
150-SB	Support Bracket for Square Rail	\$74.87	3				
150-SBPR	Support Bracket for Square Rail PR	\$101.50	3				
150SR-20	Open Square Rail - 2000mm (78 3/4")	\$741.31	3				
150SR-20PR	Open Square Rail - 2000mm (78 3/4") PR	\$1,004.52	3				
150SR-25	Open Square Rail - 2500mm (98 3/8")	\$926.75	3				
150SR-25PR	Open Square Rail - 2500mm (98 3/8") PR	\$1,255.95	3				
150SR-30	Open Square Rail - 3000mm (118 1/8")	\$1,111.99	3				
150SR-30PR	Open Square Rail - 3000mm (118 1/8") PR	\$1,506.98	3				
150SR-40	Open Square Rail - 4000mm (157 1/2")	\$1,482.64	3				
531T	Stainless steel sawcut guide	\$25.00	3				
531TPR	Saw Cut Floor Guide PR	\$45.28	3				
94P-20	Channel Polyprop - 2000mm (78 3/4")	\$28.80	2				
94P-30	Channel Polyprop - 3048mm (120")	\$43.21	2				
94P-40	Channel Polyprop - 4000mm (157 1/2")	\$57.61	2				
94P-60	Channel Polyprop - 6096mm (240")	\$86.43	2				
94PPA-A20	Poly. & Support, Anod - 2000mm (78 3/4")	\$109.48	2				
94PPA-A30	Poly. & Support, Anod - 3048mm (120")	\$164.22	2				
94PPA-A40	Poly. & Support, Anod - 4000mm (157 1/2")	\$218.96	2				
94PPA-A60	Poly. & Support, Anod - 6096mm (240")	\$328.44	2				
94PPA-BR20	Poly. & Support, Bronze Anod - 2000mm (78 3/4")	\$117.55	2				
94PPA-BR30	Poly. & Support, Bronze Anod - 3048mm (120")	\$176.32	2				

Pricing / product description subject to change without notice.

Open Bar Rail Wood**80**

Maximum Panel Weight	80kg	175lbs
Maximum Panel Height	3000mm	118 1/8"
Maximum Panel Width	1250mm	49 1/4"
Panel Thickness	35–44mm	1 3/8" – 1 3/4"

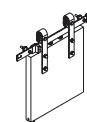
**Standard Pack (2 hangers, doorstops, guide, handle, brackets and fixings)**

Pack SS, 2000mm (78 3/4") Rail	OBF80-20	\$844.22
Pack Powdercoat black, 2000mm (78 3/4") Rail	OBF80-20PB	\$519.53
Pack SS, 2500mm (98 3/8") Rail	OBF80-25	\$955.55
Pack Powdercoat black, 2500mm (98 3/8") Rail	OBF80-25PB	\$630.85

Open Round Rail Wood

100

Maximum Panel Weight	100kg	220lbs
Maximum Panel Height	3000mm	118 1/8"
Maximum Panel Width	2000mm	78 3/4"
Panel Thickness	35-44mm	1 3/8" - 1 3/4"

Standard Pack (2 hangers, doorstops, guide, handle, brackets and fixings)

Top Fix Pack SS	ORT100	\$1,194.19
Top Fix Pack PVD Black	ORT100PR	\$1,507.17
Face Fix Pack SS	ORF100	\$1,253.35
Face Fix Pack PVD Black	ORF100PR	\$1,606.43

Rail

2000mm (78 3/4") SS	100OR-20	\$388.53
2500mm (98 3/8") SS	100OR-25	\$485.60
3000mm (118 1/8") SS	100OR-30	\$582.70
4000mm (157 1/2") SS	100OR-40	\$777.04
2000mm (78 3/4") PVD Black	100OR-20PR	\$526.58
2500mm (98 3/8") PVD Black	100OR-25PR	\$658.14
3000mm (118 1/8") PVD Black	100OR-30PR	\$789.69

Alternative Guides

Cast stainless plate with single precision bearing	106E/94	\$34.13
--	---------	---------

Channels

Polypropylene Black 2000mm (78 3/4")	94P-20	\$28.80
Polypropylene Black 3048mm (120")	94P-30	\$43.21
Polypropylene Black 4000mm (157 1/2")	94P-40	\$57.61
Polypropylene Black 6096mm (240")	94P-60	\$86.43
Polypropylene & Aluminum Bronze Anodized 2000mm (78 3/4")	94PPA-BR20	\$117.55
Polypropylene & Aluminum Bronze Anodized 3048mm (120")	94PPA-BR30	\$176.32
Polypropylene & Aluminum Bronze Anodized 4000mm (157 1/2")	94PPA-BR40	\$235.11
Polypropylene & Aluminum Bronze Anodized 6096mm (240")	94PPA-BR60	\$352.65
Polypropylene & Aluminum Anodized 2000mm (78 3/4")	94PPA-A20	\$109.48
Polypropylene & Aluminum Anodized 3048mm (120")	94PPA-A30	\$164.22
Polypropylene & Aluminum Anodized 4000mm (157 1/2")	94PPA-A40	\$218.96
Polypropylene & Aluminum Anodized 6096mm (240")	94PPA-A60	\$328.44

Support Bracket - 1 required per additional 500mm (19 3/4") on rails longer than 2m (78 3/4")

Top Fix Bracket SS	100-RB	\$33.55
Top Fix Bracket PVD Black	100-RBPR	\$45.45
Face Fix Bracket SS	100F-RB	\$41.75
Face Fix Bracket PVD Black	100F-RBPR	\$65.68

Accessories

Stainless steel sawcut guide (supplied)	531T	\$25.00
Stainless steel PVD Black sawcut guide (supplied)	531TPR	\$45.28

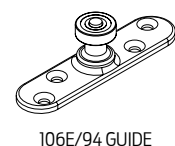
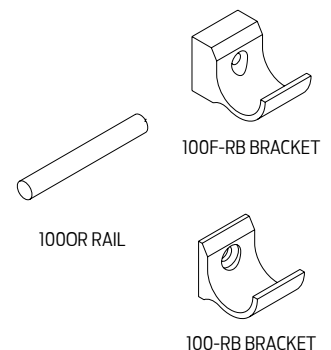
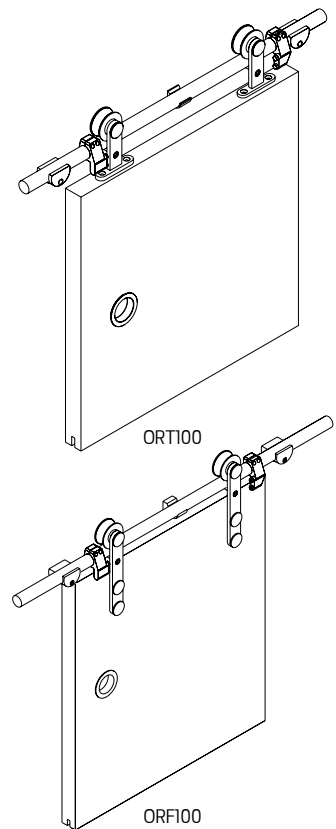

Open Square Rail Wood

150

Maximum Panel Weight	150kg	330lbs
Maximum Panel Height	3000mm	118 1/8"
Maximum Panel Width	2000mm	78 3/4"
Panel Thickness	35-44mm	1 3/8" - 1 3/4"

Standard Pack (2 hangers, doorstops, guide, handle, brackets and fixings)

SS	OST150	\$1,757.40
PVD Black	OST150PR	\$2,217.63

Rail

2000mm (78 3/4") SS	150SR-20	\$741.31
2500mm (98 3/8") SS	150SR-25	\$926.75
3000mm (118 1/8") SS	150SR-30	\$1,111.99
4000mm (157 1/2") SS	150SR-40	\$1,482.64
2000mm (78 3/4") PVD Black	150SR-20PR	\$1,004.52
2500mm (98 3/8") PVD Black	150SR-25PR	\$1,255.95
3000mm (118 1/8") PVD Black	150SR-30PR	\$1,506.98

Guides

Stainless steel sawcut guide (supplied)	531T	\$25.00
Stainless steel PVD Black sawcut guide (supplied)	531TPR	\$45.28
Cast stainless plate with single precision bearing	106E/94	\$34.13

Channels - see page 2, Open Round Rail Wood 100

Support Bracket - 1 required per additional 500mm (19 3/4") on rails longer than 2m (78 3/4")

SS	150-SB	\$74.87
PVD Black	150-SBPR	\$101.50

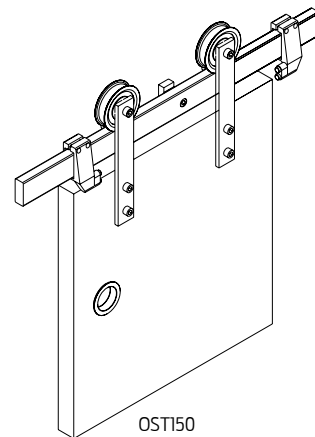

OST150

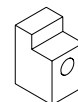

150-SB BRACKET

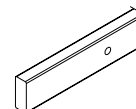

150SR RAIL

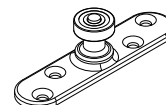

106E/94 GUIDE

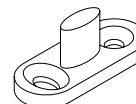

531T GUIDE

Quick Run 120 Range

57JNP	Hanger surface mount pair	\$169.77
58JNP	Hanger recessed mount pair	\$169.77
61JNP	Hanger zero clearance mount pair	\$306.04
120CS	Clip Stop	\$22.14
120SCT	Soft Close	\$120.94
120F-A20	Flush track aluminum anod, 2000mm	\$169.77
120F-A30	Flush track aluminum anod, 3000mm	\$256.07
120F-A40	Flush track aluminum anod, 4000mm	\$326.49
120F-A60	Flush track aluminum anod, 6000mm	\$490.00

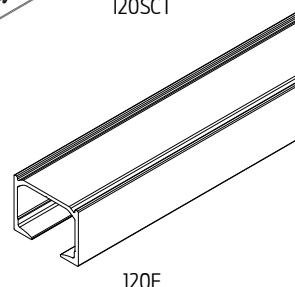
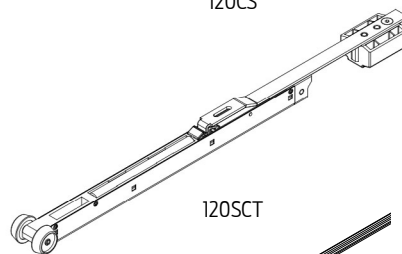
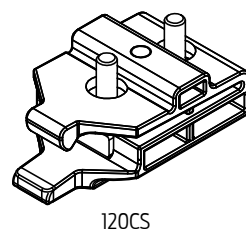
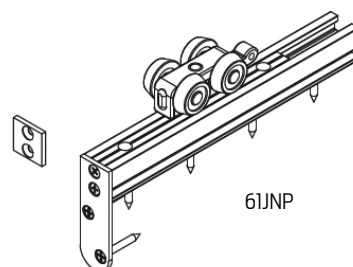
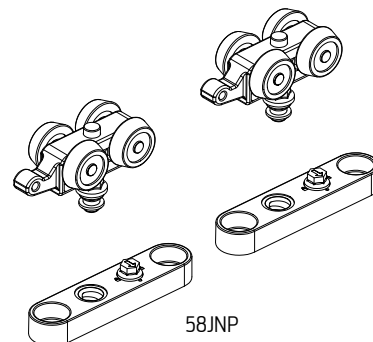
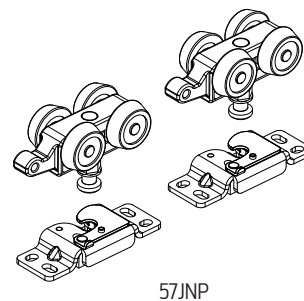

About Allegion

At Allegion (NYSE: ALLE), we design and manufacture innovative security and access solutions that help keep people safe where they live, learn, work and connect. We're pioneering safety with our strong legacy of brands like CISA®, Interflex®, LCN®, Schlage®, SimonsVoss® and Von Duprin®. Our comprehensive portfolio of hardware, software and electronic solutions is sold around the world and spans residential and commercial locks, door closer and exit devices, steel doors and frames, access control and workforce productivity systems.

For more, visit www.allegion.com

KRYPTONITE ■ LCN ■  ■ STEELCRAFT ■ VON DUPRIN